

# Parts List

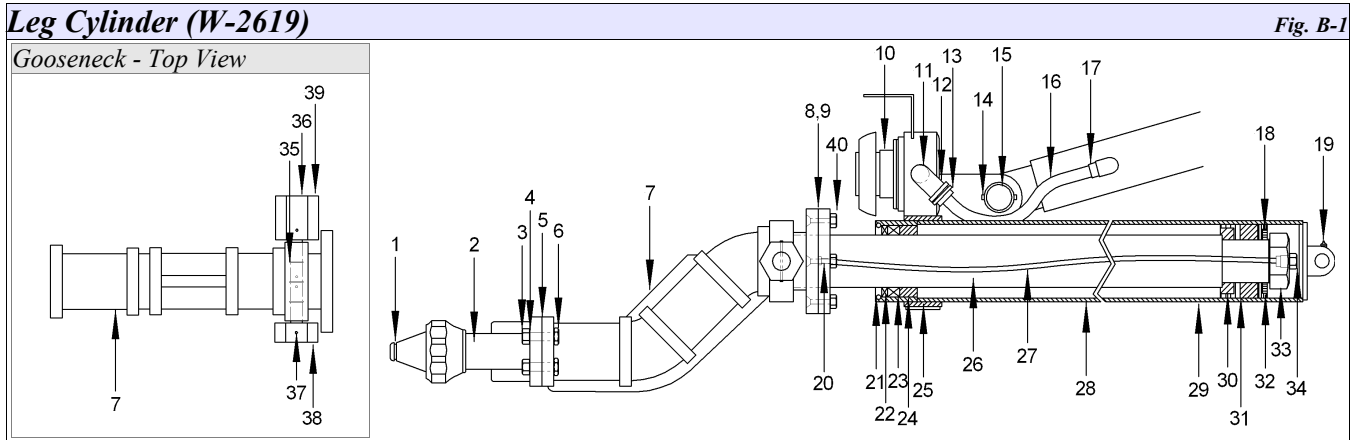

Leg Cylinder (W-2619)			Fig. B-1
No.	Part No.	Description	Qty
1	6227-15	"O" Ring	1
2	C-109HD or C-109GD	Heavy Duty Secan Drill Adapter Gardner-Denver Drill Adapter	1
3	J-5050	Hex Nut	4
4	J-5040	Lockwasher	4
5	Y-1384	Gasket	1
6	J-5060	Bolt	4
7	WB-2501	Gooseneck	1
8	Y-269	Packing Cup Gasket	1
9	2813002	"O" Ring - Optional	1
10	J-213AC	Self-Relieving Pressure Regulator	1
11	J-5070	Close Nipple	2
12	J-5080	90° Elbow	2
13	J-5090	Hex. Bushing	2
14	59-077-375-1500	Roll Pin	1
15	Y-1647	Leg Lift Pin	1
16	1525-4	Hose	2
17	4738-4-4B	Hose Fitting	4
18	Y-1236	Cup Follower	1
19	1610	Grease Fitting	1
20	J-5100	Transfer Hose Fitting	1

Leg Cylinder (W-2619)			Fig. B-1
No.	Part No.	Description	Qty
21	5000-275	Retaining Ring	1
22	275-HD2	Rod Wiper	1
23	Y-274	Set Rod Packing (Molythane)	1
24	Y-1252	Packing Cup	1
25	Y-271	Piston Rod Bearing	1
26	Y-1730	Piston Rod (Bare)	1
27	J-5110	Transfer Hose, 117½" Long	1
28	X-1656	Leg Cylinder, Bare	1
29	Y-1237	OPTIONAL: Inlet Cup Follower, 13/16" Long	1
30	W-2590	Inlet Cup Follower, 12" Long	1
31	Y-1238	Piston Head (Brass Guide)	1
32	Y-1241	Cup Packing (Molythane)	2
33	Y-1250	Rod Nut	1
34	J-5120	Transfer Hose End Fitting	1
35	6227-11	"O" Ring (Feed / Reversing Valve)	3
36	Y-1745	Reverse Valve	1
37	59-048-250-1750	Roll Pin	2
38	Y-2030-A	Valve Handle - short, no pin	1
39	Y-2030-B	Valve Handle - long, w / pin	1
40	J-5285	Bolt	4